

Filling valve 4181 double

- Dezincification resistant brass
- 15CU compression fittings
- Check valve



Description

Filling valve.

Construction

Double ball valve in dezincification resistant brass with spring loaded check valve. Connection compression fittings 15CU. Seals in PTFE and gaskets in NBR. Key grip. T-handle in aluminium

Technical data

Body	Dezincification resistant brass CW625N
Ball seal	PTFE
Stem gaskets	NBR/NBR
Check valve	POM

Maximum working pressure: 10 bar
Maximum working temperature: +90°C
Minimum working temperature: +2°C

Marking

CR, flow direction arrow.

Maintenance

The ball valves must be operated periodically, two to three times a year.

Installation

Tighten nuts with a fixed spanner or wrench according to the prescribed installation instructions. Support sleeves must be used for all pipe types.

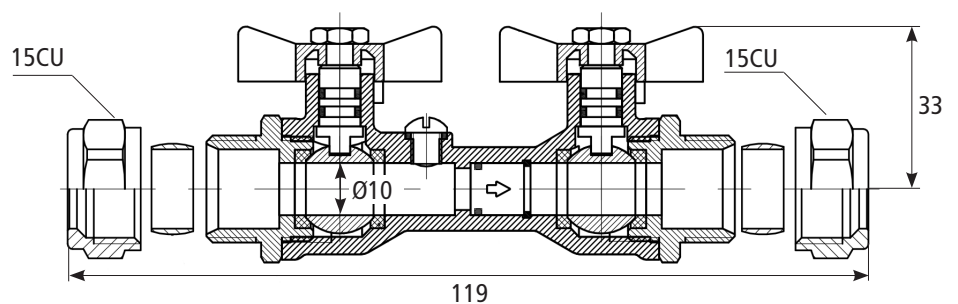

Item number	Description	Connection	Length	Centrum height	Weight (kg per piece)
0441811502	Filling valve double 4181-15, 15CU, T-handle, check valve	15CU	119	33	0,29

All dimensions in millimetres

Subject to technical changes and corrections without notice