

Filling device 752 1"- 1 1/4"

- Male thread 1"- 1 1/4"
- Changeable integrated strainer
- Double cap seal



Description

Filling device including strainer.

Construction

Ball valve with integrated strainer insert and mesh 0,6mm for closing the circulation loop. Connection thread male 1"- 1 1/4".

The filter ball valve features seals in EPDM between cap and body. Ball valves for draining/filling with built-in strainer for shutting off fill and drain lines.

Marking

DN, PN and flow direction arrow.

Maintenance

Close valve and clean strainer when necessary. The ball valve must be operated periodically, two to three times a year. See further information on Impel's homepage.

Technical data

Body and T-pipe	Brass CW617N
Strainer insert	Stainless steel SS304
Ball seal	PTFE
Stem gasket	PTFE
Cap seal (o-ring)	EPDM
Cap seal (gasket)	EPDM

Maximum working pressure: 16 bar
 Maximum working temperature: +100°C
 Minimum working temperature: -20°C
 Kv-value: see chart
 Maximum kW*: 1" 12kW, 1 1/4" 25kW

Media water - glycol mixture max 60%.
 Media water - ethanol mixture max 50%.

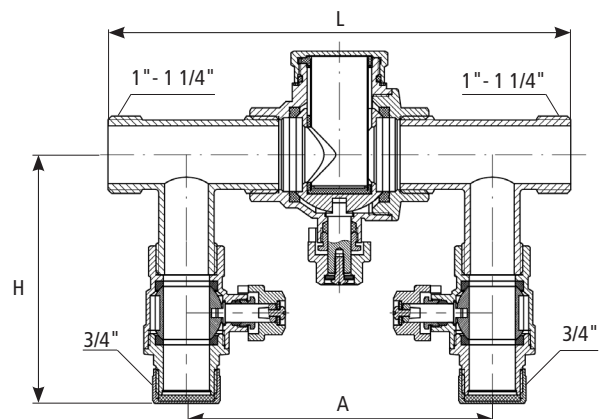

Item number	Description	Connection thread	Length L	Height H	A	Kv** (m³/h)	Insulation included	Weight (kg per piece)
0751000025	Filling device 752-25, 1"M, key grip	2 x 1"M, 2 x 3/4"M	200	107	133	12,57	No	1,84
0752000025	Filling device 752-25, 1"M, key grip, insulation	2 x 1"M, 2 x 3/4"M	200	107	133	12,57	Yes	1,92
0751000032	Filling device 752-32, 1 1/4"M, key grip	2 x 1 1/4"M, 2 x 3/4"M	251	96	171	24	No	2,51
0752000032	Filling device 752-32, 1 1/4"M, key grip, insulation	2 x 1 1/4"M, 2 x 3/4"M	251	96	171	24	Yes	2,59

All dimensions in millimetres

* Theoretical value at 0.1 bar pressure drop across the filter ball valve and a 5°C temperature differential

** The Kv value applies to the filter ball valve

Subject to technical changes and corrections without notice

Filling device 752 and 756

Heating systems need to be filled, drained and protected!

The filling device - is an all-in-one, fill & drain valve assembly offering reliable operation in all types of flow systems. The valve assembly features the necessary components for use of brine in heat pumps and other heating systems. Additionally, the valve assembly is reversible.

The stylish, compact design includes our handy filter ball valve.

On the filter ball valve housing, an arrow indicates the flow direction to catch contaminants before they reach sensitive system parts. Lift out the strainer insert and flush it clean.

When using brine, there is always a risk of ice formation. As a result, insulation of the product is important.

Filling device dimensions 1" and 1 1/4" are supplied complete with insulation.

Dimensions 3/4", 1 1/2" and 2" should be insulated locally.

The filling device can be used in many other systems that require filling, draining and filtration.

The filling device should be cleaned when the system is first started up, and after that at regular intervals. Apart from this, the valve assembly does not require any maintenance but should be inspected regularly.

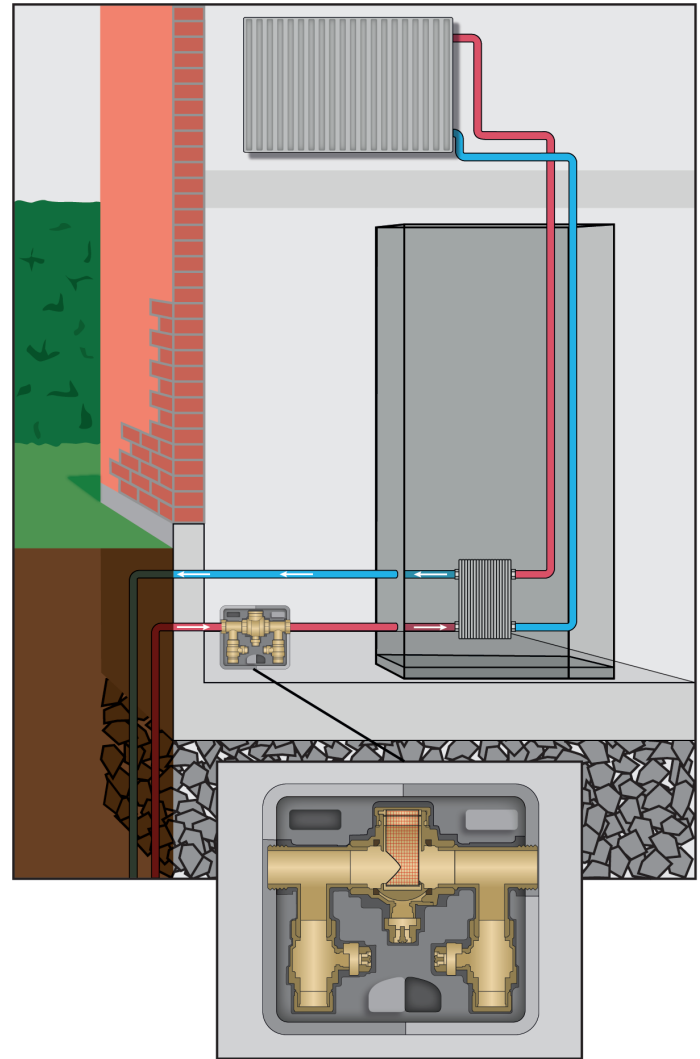

Filling device 1" - 1 1/4"

Filling/draining the system (Filling device 1" - 2"):

